

# ELECTRONIC FLOW METERS

## K500 Preset Batch Nozzle Meter



THE **K500** NOZZLE METER WAS DEVELOPED FOLLOWING A CAREFUL ANALYSIS OF THE NEEDS OF THE MARKET. ITS INNOVATION LIES IN ITS ABILITY TO PERFORM PRE-SELECTED DISPENSING OF OIL, ANTI-FREEZE AND OTHER FLUIDS COMPATIBLE WITH ITS MATERIALS BY EXPLOITING THE INTEGRATION OF THE FUNCTIONS OF A DISPENSING VALVE AND A FLOW METER.

IN ADDITION TO MANUAL DISPENSING, IT IS POSSIBLE TO DISPENSE IN AUTOMATIC MODE. THE AMOUNT TO DISPENSE IS PRE-SELECTED AND WHEN IT IS REACHED, THE METER AUTOMATICALLY CLOSES THE VALVE AND THE NOZZLE STOPS DISPENSING.

THE K500'S FUNCTIONS ARE EXPANDED BY A BROAD MENU AND ARE MANAGED BY A BATTERY-POWERED ELECTRONIC CIRCUIT CARD WITH MICROPROCESSOR. THE OVAL GEAR METER ALLOWS OBTAINING HIGH COUNTING PRECISION WITH LOW LOSS OF HEAD.

THE NOZZLE ALLOWS THE FLOW METER TO BE CALIBRATED ON-SITE USING AN EASY PROCEDURE. DISPENSING IS SIMPLIFIED BY AN ARTICULATED END THAT ALLOWS REACHING ANY POSITION.

THE EXTERIOR ERGONOMIC AND ANTI-SHOCK HOUSING AND THE TRIGGER PROTECTION TO PREVENT ACTIVATION MAKE THIS NOZZLE METER ONE OF A KIND AND INDISPENSABLE FOR OPERATORS IN THE INDUSTRY.

**PERFORMANCE SPECIFICATIONS**

- FLOW RATE FROM 1 TO 30 LITRES/MIN
- PRECISION PLUS OR MINUS 0.5% OVER THE ENTIRE FLOW CAPACITY RANGE (PLUS OR MINUS 0.3% PTB APPROVED MODEL)
- REPETITIVENESS PLUS OR MINUS 0.2%
- VISCOSITY RANGE FROM 5 - 2000 cSt
- MAXIMUM WORKING PRESSURE: 70 BAR MAX
- PRESET QUANTITIES 0.1 L/MIN - 99.9 L/MIN MAX
- QUANTITY DISPENSED INDICATORS WITH VARIOUS UNITS OF MEASURE

**TECHNICAL SPECIFICATIONS**

- PRESSURE MOULDED METER BODY, RESISTANT TO HIGH PRESSURES, PROTECTED BY A STRUCTURE OF ANTI-SHOCK, THERMO-HARDENED PLASTIC
- TRIGGER PROTECTION TO PREVENT ACCIDENTAL OPERATION
- ENTRY WITH 1/2" GAS SWIVEL CONNECTOR AND INCORPORATED FILTER
- BALANCED VALVE TO REDUCE PRESSURE ON THE TRIGGER
- OVAL GEAR METER, WITH ACETAL RESIN GEARS. SINGLE-CHANNEL PULSER TYPE, CLEAN CONTACT EXIT SIGNAL
- ELECTRONIC CIRCUIT CARD WITH MICROPROCESSOR FOR MANAGING CARD FUNCTIONS
- LCD WITH FOUR DIGIT PARTIAL SUPPLY INDICATOR (HEIGHT 11.5MM) AND NON-RESETTABLE, SIX DIGIT TOTAL INDICATOR (HEIGHT 5MM)
- POWERED BY FOUR 1.5V AA SIZE BATTERIES
- TRIGGER LOCKING/UNLOCKING SYSTEM FOR PRE-SELECTED DISPENSING
- ARTICULATED END

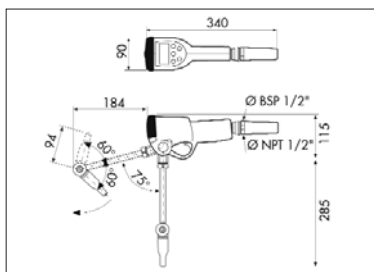

**TECHNICAL INFORMATION** CODE

Description	Flow Rate L/min	Max Working Pressure		IN Connection	Weight Kg	Package mm	CODE
		Bar	Psi				
K500	1 ÷ 30	70	994	1/2"	1.8	300x160x150	<b>68700B</b>

**1/2" SWIVEL RUBBER PROTECTORS**

Colour Code Black	<b>9659</b>
Colour Code Yellow	<b>9757</b>
Colour Code Green	<b>9758</b>
Colour Code Red	<b>9899</b>
Colour Code Blue	<b>9955</b>